



-  Detention Basins
-  Open Space
-  Pedestrian Pathways



**LEGEND**

 EXISTING STAGES

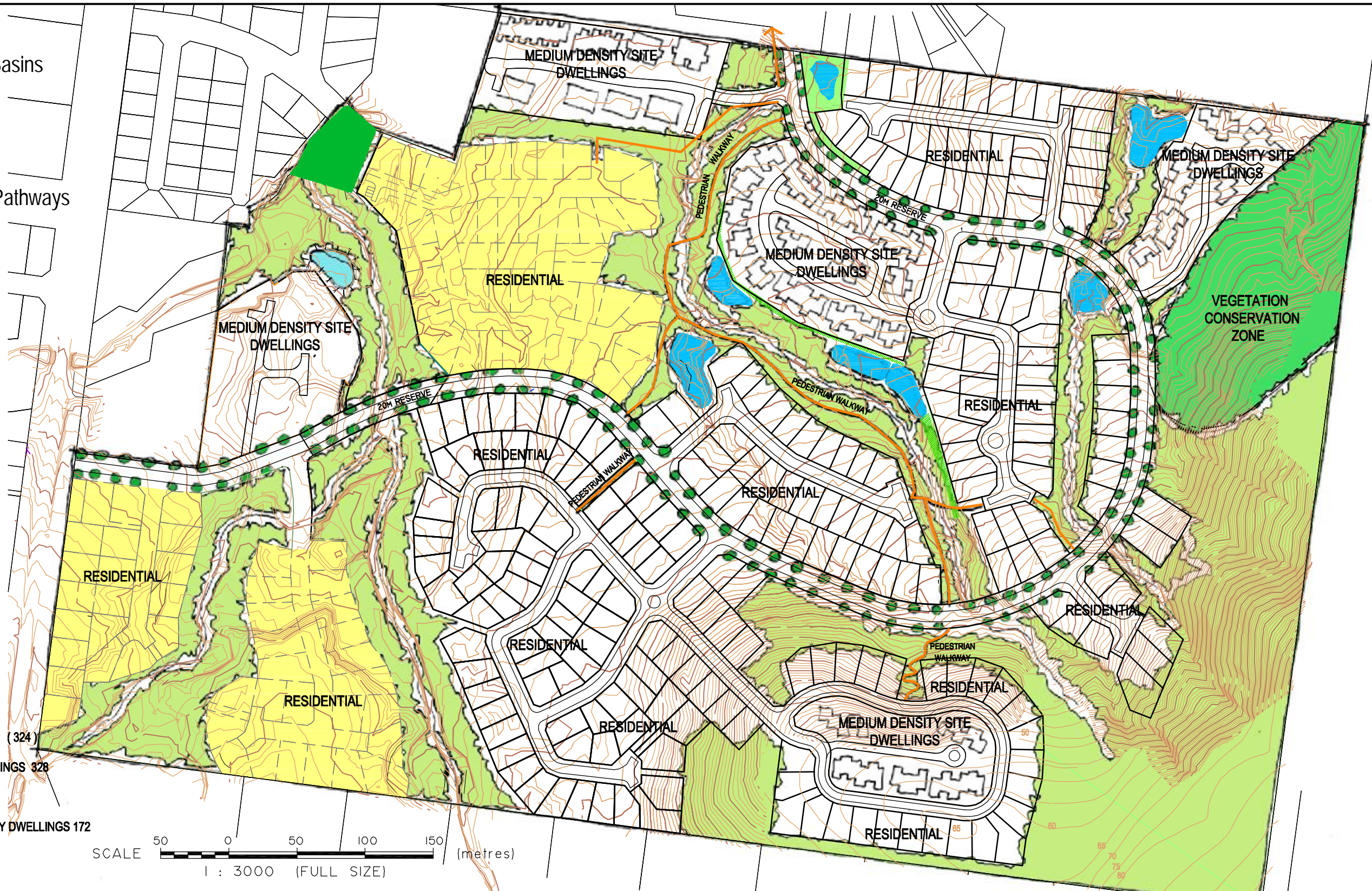
TOTAL NUMBER OF PROPOSED LOTS ( 324 )

TOTAL NUMBER RESIDENTIAL DWELLINGS 328

MEDIUM DENSITY SITES ( 5 )

TOTAL NUMBER OF MEDIUM DENSITY DWELLINGS 172

TOTAL DWELLINGS 500

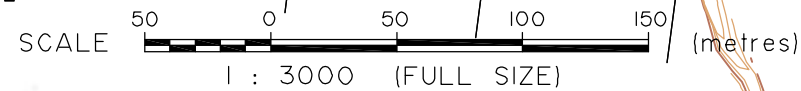

PRELIMINARY LAYOUT

**DISCLAIMER**  
 Please note that a preliminary development concept plan or development estimate produced by Burchill VDM Pty Limited or its subsidiary companies for a given parcel of land has been produced to provide an indication of the possible development outcome based on a preliminary appraisal of the facts and constraints relating to the parcel, but without the benefit of detailed technical assessment of the town planning constraints or detailed survey. The appraisal process which involves preparation of technical reports, responding to the Council information requests and information requests from State and Federal referral agencies and finally receipt of a decision notice from Council will involve many changes to the development proposal to take account of a range of constraints and requirements of a range of legislation, guidelines and town planning outcomes. The information thus so given is for preliminary feasibility purposes only and shall not be relied upon as a definitive statement of the development rights or suitability of the land.

A3: FULL SIZE  
 DO NOT SCALE FROM THIS DRAWING

# AIRLIE RETREAT

# MASTERPLAN



ACN 010 140 495  
 CIVIL & STRUCTURAL CONSULTING ENGINEERS & PLANNERS  
 142 Bundall Road, Surfers Paradise, Qld. 4217  
 Phone (07) 5574 0511  
 Fax Civil (07) 5574 0011  
 Fax Structural (07) 5574 0505  
 Email info@burchillvdm.com.au



DRAWN : GSR DATE : 07-07-2008

FILENAME : B:\2006\06-3699\_Airlie\_Retreat\Planning\Acad\MASTERPLAN.dwg

THESE DESIGNS AND DRAWINGS ARE COPYRIGHT AND ARE NOT TO BE USED OR REPRODUCED WITHOUT THE WRITTEN PERMISSION OF BURCHILL VDM PTY LIMITED

DRAWING No. : AMENDMENT :

06-3699-002